

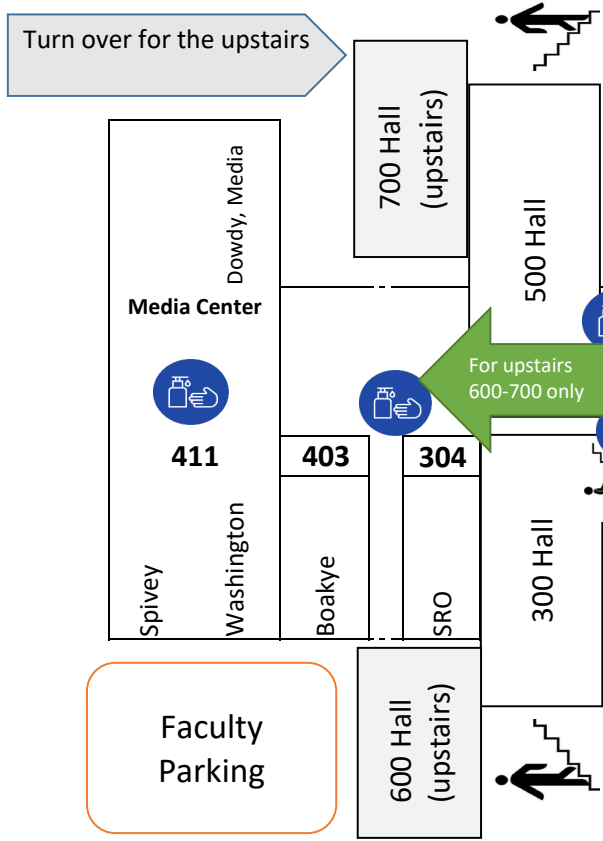

Turn over for the upstairs



For upstairs 600-700 only

Student Driver

Guidance	Page	Bryant	Knowles	Matthews	Thagard	Jones
251	246	244	239	210	207	205
EC	EC	McClure	Holloman	Noles	Bremer	Front Office
237	233	232	229	225	222	

	McCray 938	McIntyre 937
Aux Gym	934	Weight Rm
	931	Chavez Blanchard Training Rm
	930	Boys Locker Room
	912	Girls Locker Room
Main Gym	Health Room	Regan
903	907	908
Lobby	Cafeteria	Downey
		820

Bus Riders

Faculty Parking

Car Rider Entrance

Twitter @SoLeeHS
Instagram slhs_cavs

Guidance Team Room 251

Dial	12 th
Roberts, K.	11 th
Neal, Ken	10 th
McDonald	9 th
Yarborough	Admin. Ast

Southern Lee High School
 2301 Tramway Road Sanford, NC 27332
 919-718-2400 phone 919-718-2410 fax
 Principal: Mrs. Molly Poston
 Mascot: Cavaliers Conf: Sandhills Athletic Conf

Admin & Front Office Team

Principal	Mrs. Poston	Front Office
AP [11 th]	Ms. Colvin	251
Dean [12 th]	Mr. Gore	Front Office
AP [10 th]	Ms. Salter	607
AP [9 th]	Mr. Wilson	302
Nurse	Mrs. Almond	Front Office
Ath Trainer	Mrs. Chavez	931
Admin Ast.	Ms. Mauldin	Front Office
Admin Ast.	Mrs. Villalba	Front Office
Athletic Dir	Mr. Purnsley	Front Office

Connor	Showalter	Everts	Risseler	Stewart	Lyckowski	Williams	Palmer	Knight	Brewer	Clark	Adams	Padilla	Bloedorn
622	620	618	616	614	612	610	704	706	708	710	712	714	716

631	629	619	615	609	607	604
Willix	Allen	Norton	Maldonado	Goldberg	Salter	Neal, L

703	705	713	715	721	725	731
Womack	Blackmon	Brown	Roberts, S	Quick	McNeill	Cox

Southern Lee High School Upstairs 600 & 700

Koutroumpis	Burns	Raynor	Bivans	Paye	Snidow	Wilson	Smith	Yow	White, M	Guin	Krivensky	Gill	Nooning
318	316	314	312	310	308	302	504	506	508	510	512	514	516

331	329	319	315	309	307
Ewing	Crockett	Braxton	Crowley	Gelling	Wilkins

505	507	509	515	517	527	529
Bly	DeAvilia	Gonzalez	Ward	Randolph	DiCiancia	

Use center stairwell to go upstairs to 600-700

Use center stairwell to go upstairs to 600-700

Southern Lee High School Downstairs 300 & 500